

TOP VIEW

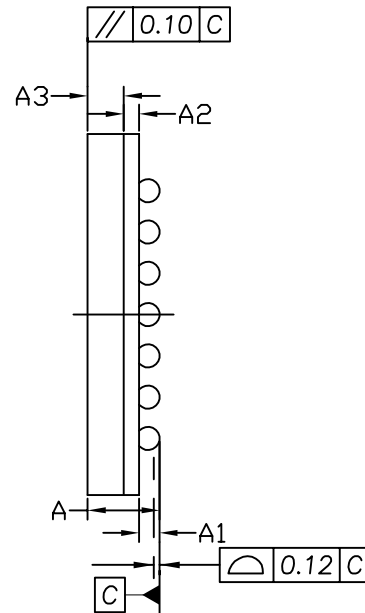

SIDE VIEW

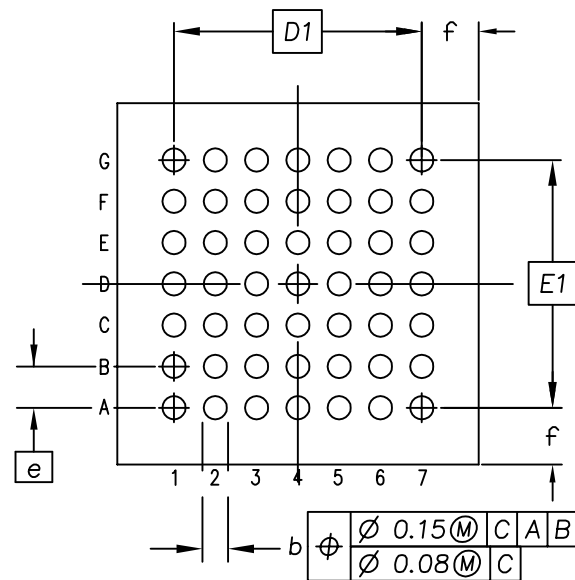

BOTTOM VIEW

REV	DESCRIPTION	DATE	BY
A	NEW DRAWING	-	GREG P.
B	Updated 'b' to 0.45	-	Timothy L.

SYMBOL	MILLIMETER			INCH		
	MIN	NOM	MAX	MIN	NOM	MAX
A	1.25	1.35	1.45	.049	.053	.057
A1	0.30	0.35	0.40	.012	.014	.016
A2	0.25	0.30	0.35	.010	.012	.014
A3	0.67	0.70	0.73	.026	.028	.029
b	0.40	0.45	0.50	.016	.018	.020
D	6.90	7.00	7.10	.272	.276	.280
D1	4.80 BSC			.189 BSC		
E	6.90	7.00	7.10	.272	.276	.280
E1	4.80 BSC			.189 BSC		
e	0.80 BSC			.031 BSC		
f	1.00	1.10	1.20	.039	.043	.047

NOTES :

1. DIMENSIONING & TOLERANCING PER ASME Y14.5M - 1994.
2. CONTROLLING DIMENSIONS ARE IN MM.
3. \triangle DETAILS OF A1 CORNER ARE OPTIONAL, AND MAY CONSIST OF INK DOT, LASER MARK OR METALIZED MARKING, BUT MUST BE LOCATED WITHIN THE ZONE INDICATED.
4. SOLDER BALLS, ARE NORMALLY A TIN LEAD SOLDER.
5. REFER TO JEDEC OUTLINE MO-205 FOR DATUMS. FEATURES AND DIMENSIONS NOT SHOWN.
6. PRIMARY DATUM C AND SEATING PLANE ARE DEFINED BY THE SPHERICAL CROWNS OF THE SOLDER BALLS.

PROJECTION 	UNIT MM	 Jalan S. Parman Kav. 201 Batamindo Industrial Park, Muka Kuning Batam Island 29433, Indonesia Telp:(62)-770-611888 Fax:(62)-770-611555	
APPROVAL	DATE	TITLE 49 BALLS 7x7mm FBGA PACKAGE OUTLINE PITCH - 0.80mm (0.7mm Mold, 0.30mm Sub Thk., 0.45mm ball)	
DRAWN GREG P.	02/18/05	DRAWING NO. R0049PO-05	
CHECKED VIVIAN B.		REV. B	
APPROVED TOTIE S.		SCALE DO NOT SCALE SHEET 1 OF 1	
RELEASED DCC			